

# Tiered Raised Veggie Garden

By **Lazy Guy DIY**

Difficulty

Moderate

This tiered raised garden is a perfect fit for any yard or porch with pesky rabbits that might want to steal your veggies. It's made with cedar planks that are rot resistant and pressure treated lumber for the frame only. Veggies and dirt are in contact with the cedar and gardening cloth only.

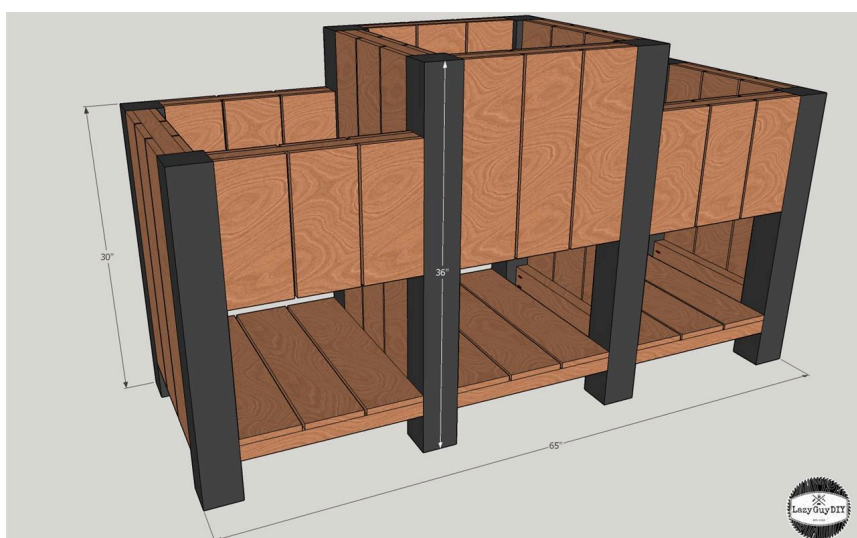

# Tools

## Kreg Tools



[Kreg® Pocket-Hole Jig 720](#)

## Other Tools

Miter Saw

Square

Tape Measure

Thickness Planer

Clamps

Drill (cordless)

Impact Driver

Nail Gun

Stapler

# Materials

## Wood Products

- 3** Board , 4x4 , 96"
- 8** Board , 2x4 , 96"
- 20** Cedar Fence Plank , 6 Foot Cedar Fence Plank , 72"

## Hardware & Supplies

- 1** 250 Ct - 2.50" Blue Kote Kreg Pocket Screws
- 1** 1" Stainless Steel 18 Gauge Brad Nails
- 1** Roll Of Durable Garden Cloth
- 1** T-50 Staples

# Cut List & Parts

- 4** Center Planter Frame , 4" X 4" X 36"
- 4** Outside Planter Frame , 4" X 4" X 30"
- 32** Cross Supports , 2" X 4" X 17"
- 6** Outer Planter Cedar Planks , 5.5" X 26"
- 6** Center Planter Cedar Planks , 5.5"x 32"
- 12** Outside Planter Face Planks , 5.5" X 12"
- 6** Center Planter Face Planks , 5.5" X 18"
- 9** Lower Shelf Planks , 5.5" X 24"
- 12** Inside Cedar Planks , 5.5" X 12"
- 6** Planter Shelf Supports , 2" X 4" X 19.75"
- 9** Inside Planter Shelves , 5.5" X 17"
- 18** Inside Planter Planks , 5.5" X 9.875"

# Directions

**1****Step 1 - Supports**

Cut (4) pressure treated 4x4's to 30" (green) for the outside planters and (4) 4x4's to 36" (blue) for the inside planter. Then cut (12) 17" pieces of pressure treated 2x4 (red) for the cross supports. Using your Kreg Jig, pre-drill two holes into each end of the 2x4's set to a depth of 1.50". Attach the 17" 2x4's using 2.50" exterior pocket screws and exterior wood glue. Inset the 2x4's roughly 0.625" to account for the thickness of the cedar planks going on the outside of the planters. The first 17" support will be flush with the top, the second 12" from the top and the third will be 4" from the bottom.

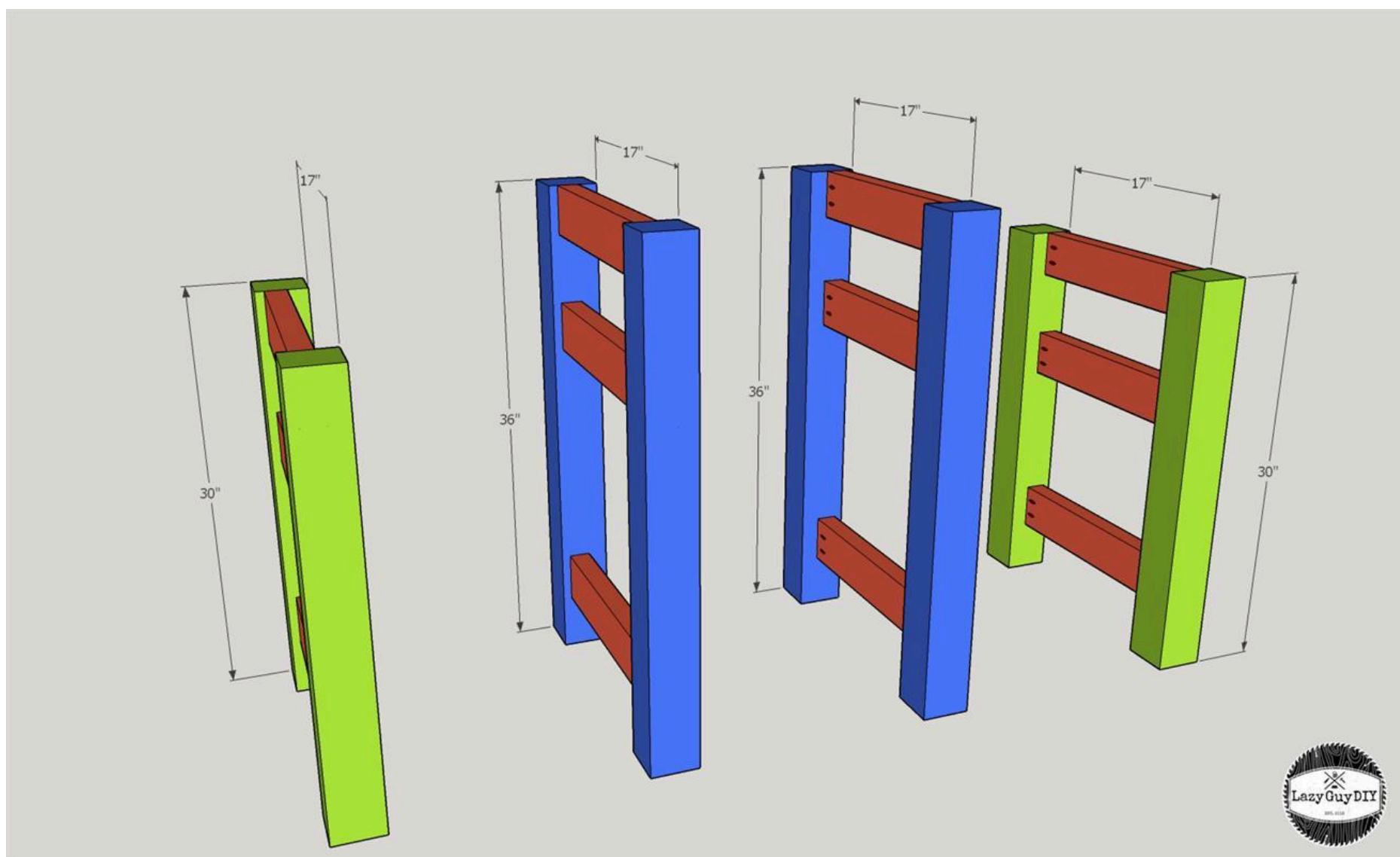



## 2

### Step 2 - Side Supports

Cut (14) 2x4's to 17" and pre-drill a pair of pocket holes set to a depth of 1.50" on your Kreg Jig into both ends of each board. Starting with the 36" 4x4 frame, attach the first 17" 2x4 flush with the top (as shown) with 2.50" blue kote pocket screws and exterior wood glue. Be sure to inset each of these 2x4's the width of the cedar planks. Attach the second 17" 2x4 5" lower. The total distance from the top to the bottom of the second 2x4 should be 12". Do the same with the 3rd 2x4 with a spacing of 18".

Complete the same process on the 30" frame starting at the top and then installing the last 2x4 with the same 12" spacing. Then attach the two 30" frames to the 36" frame as shown with the same 2.50" blue kote screws.

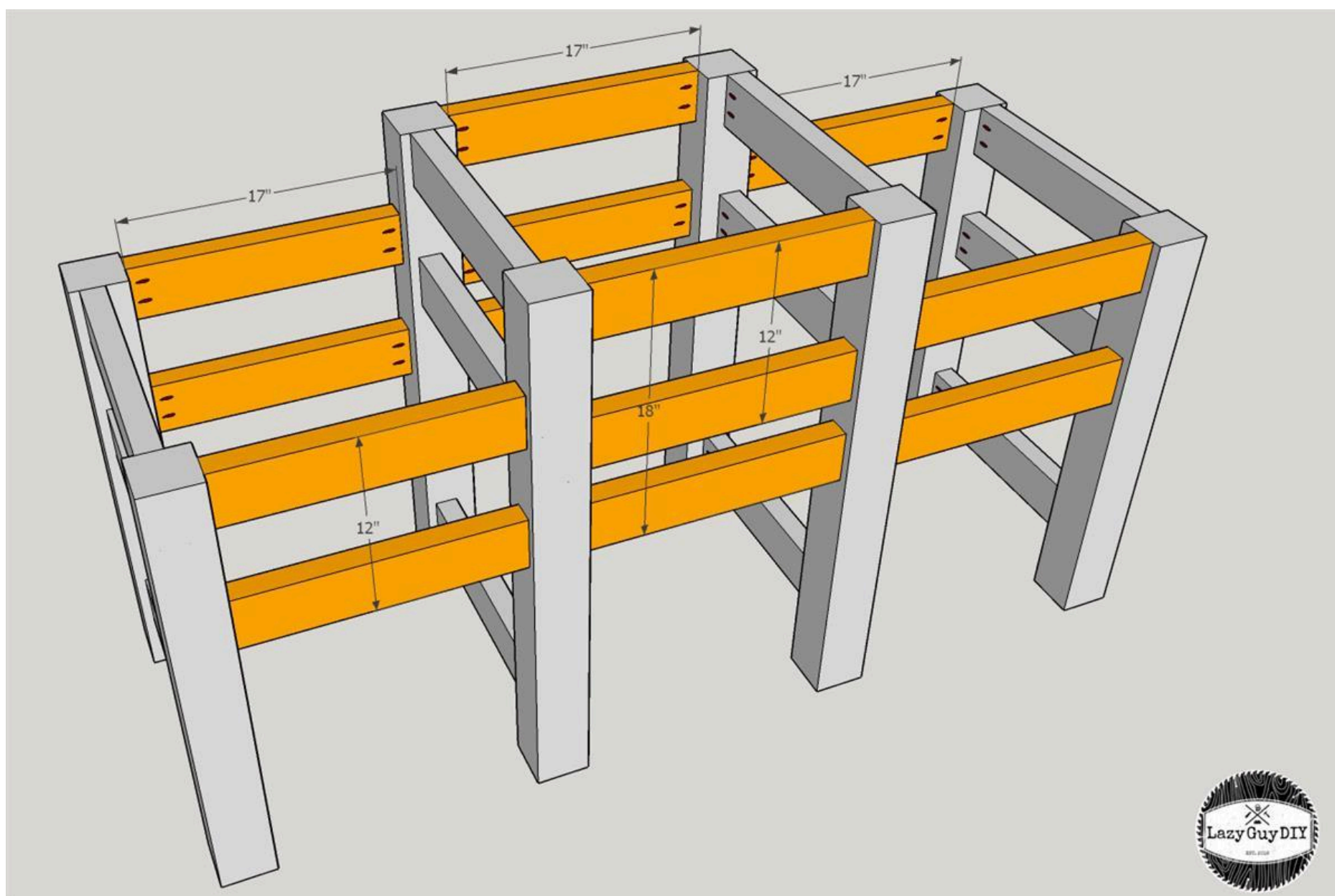

### 3

#### Step 3 - Install Outside Planks

If you want a smoother look to the cedar planks, you can run them through your thickness planer to take the top layer off on the outward facing side. It's strictly aesthetic.

For both 30" outside frames, cut (3) 26" planks. Attach on the outside as pictured with exterior wood glue and a brad gun with Stainless Steel brad nails (I used 1"). Galvanized brads will corrode in cedar. Attach the two outside pieces first so they are flush with the frame and then center the middle with even spacing (roughly 1/4").

For the 36" frame, cut 3 cedar panels for both sides at 32" and install the same way.

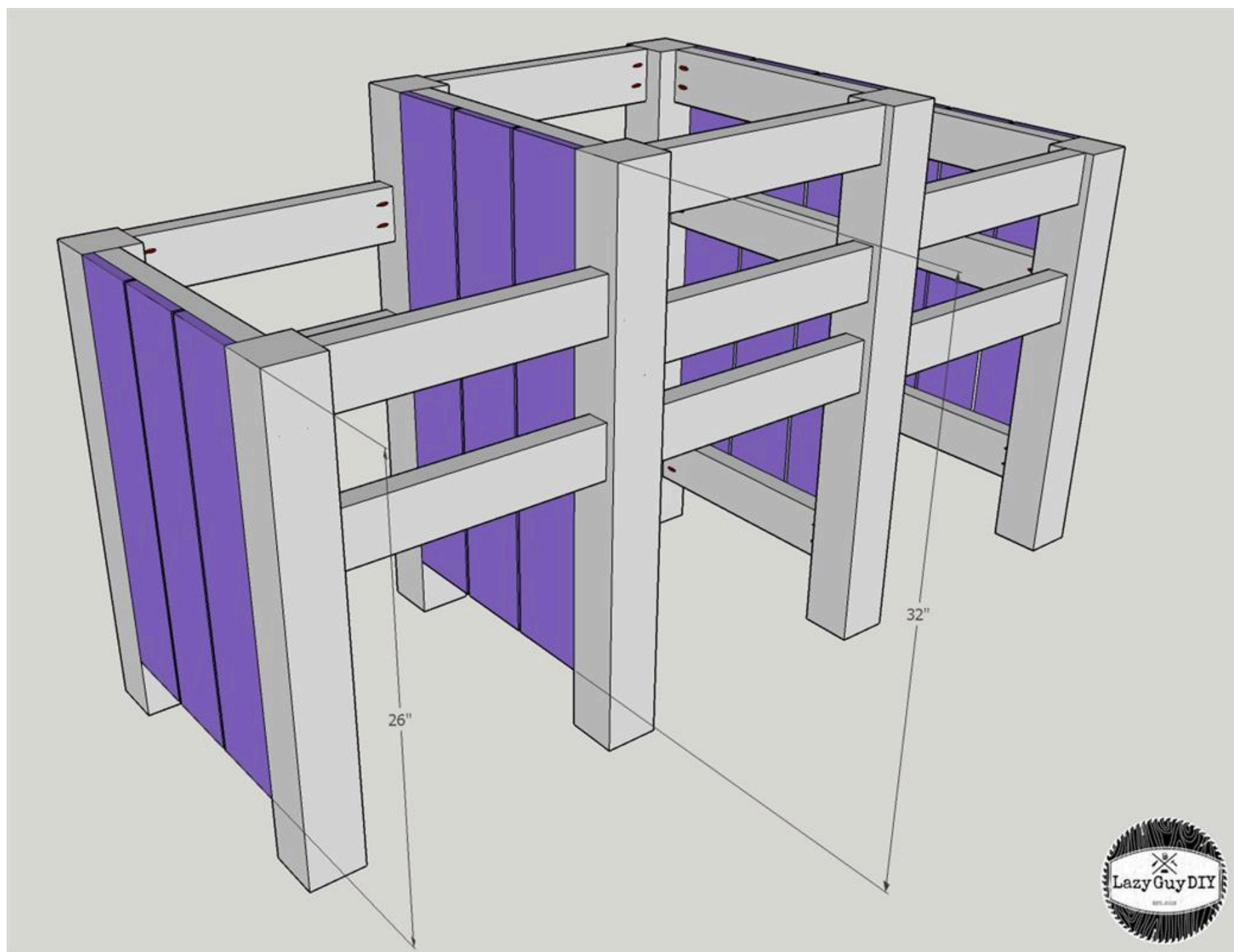

# 4

## Step 4 - Install Side Planks

Cut (3) 12" cedar planks for all four remaining outside surfaces on the 30" planters and install with exterior wood glue and stainless steel brad nails. Keep the same even spacing between planks.

On the 36" planter cut (3) 18" cedar planks for both sides and install with exterior wood glue and stainless steel brad nails.

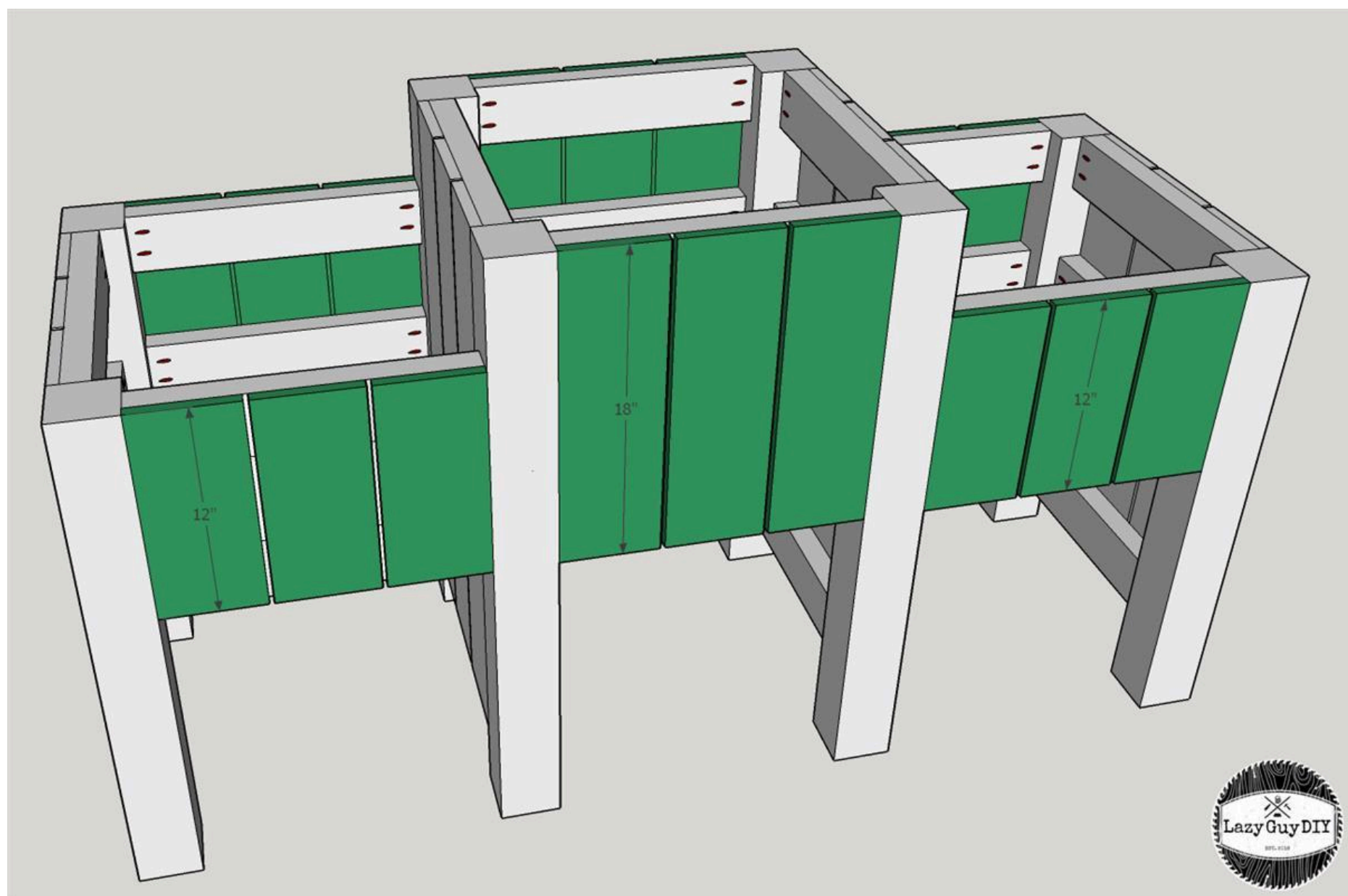

## 5

**Step 5 - Shelf Supports**

Cut (6) 2x4's to 17" and pre-drill with a pair of 1.50" pocket holes into each end. Attach at a height of 4" from the bottom as shown in the image with 2.50" blue kote pocket screws and exterior wood glue. You can go pocket holes up or down, they are shown on the top for easy viewing in the diagram.

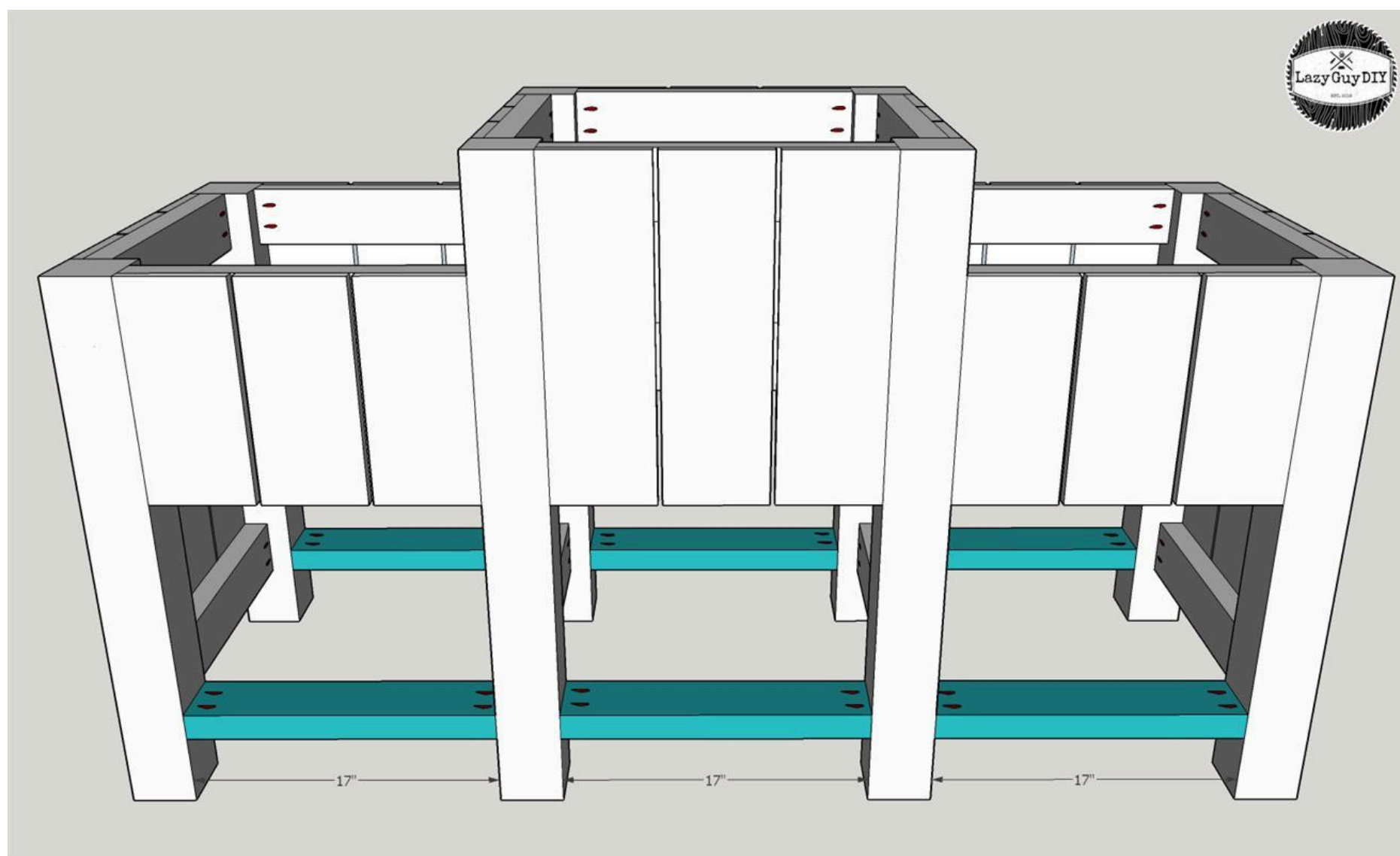



**6****Step 6 - Install Lower Shelves**

Cut (3) cedar planks for each planter frame to 24". Install with exterior wood glue and stainless steel brad nails.

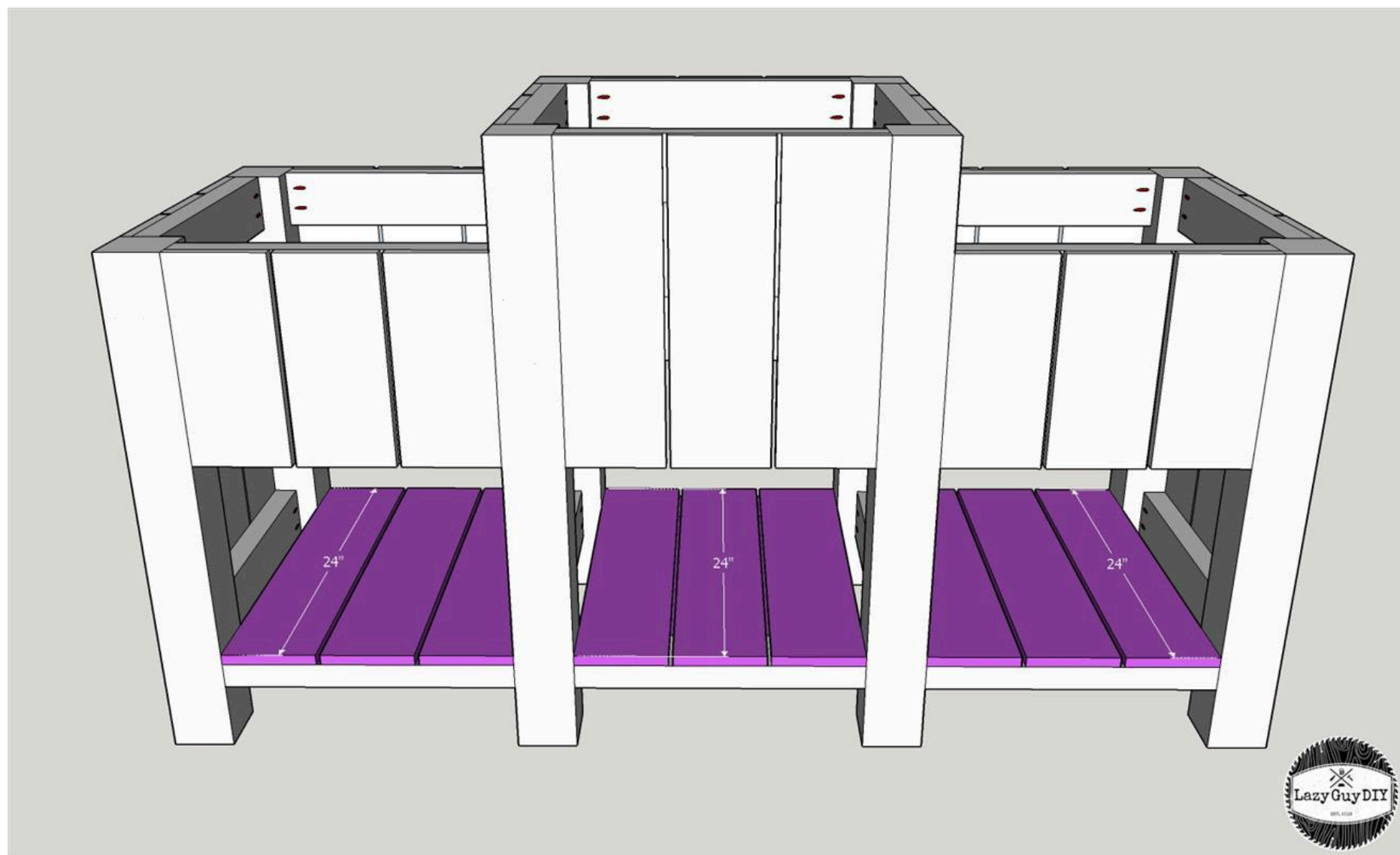

**7****Step 7 - Install Inside Planks**

Cut (3) cedar planks to 12" for each of the four inside panels highlighted in blue. You do not want to install the other inside panels until Step 10.

Attach with exterior wood glue and stainless steel brads.

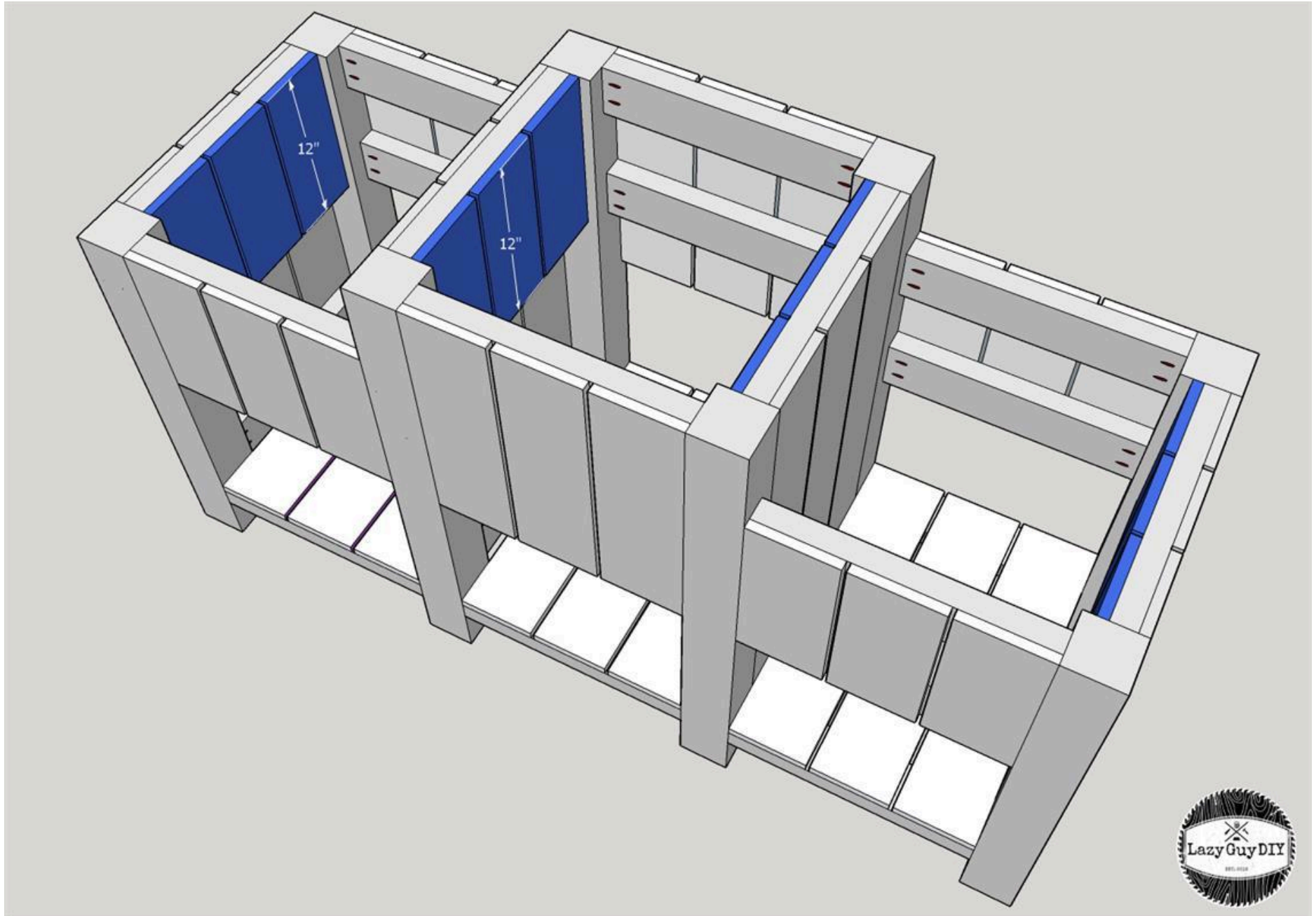

**8****Step 8 - Inside Shelf Support**

Cut (6) 2x4's to 19.75" and pre-drill a pair of 1.50" pocket holes into each end. Install flush to the bottom of each 12" support with exterior wood glue and 2.50" blue kote screws as pictured in yellow.

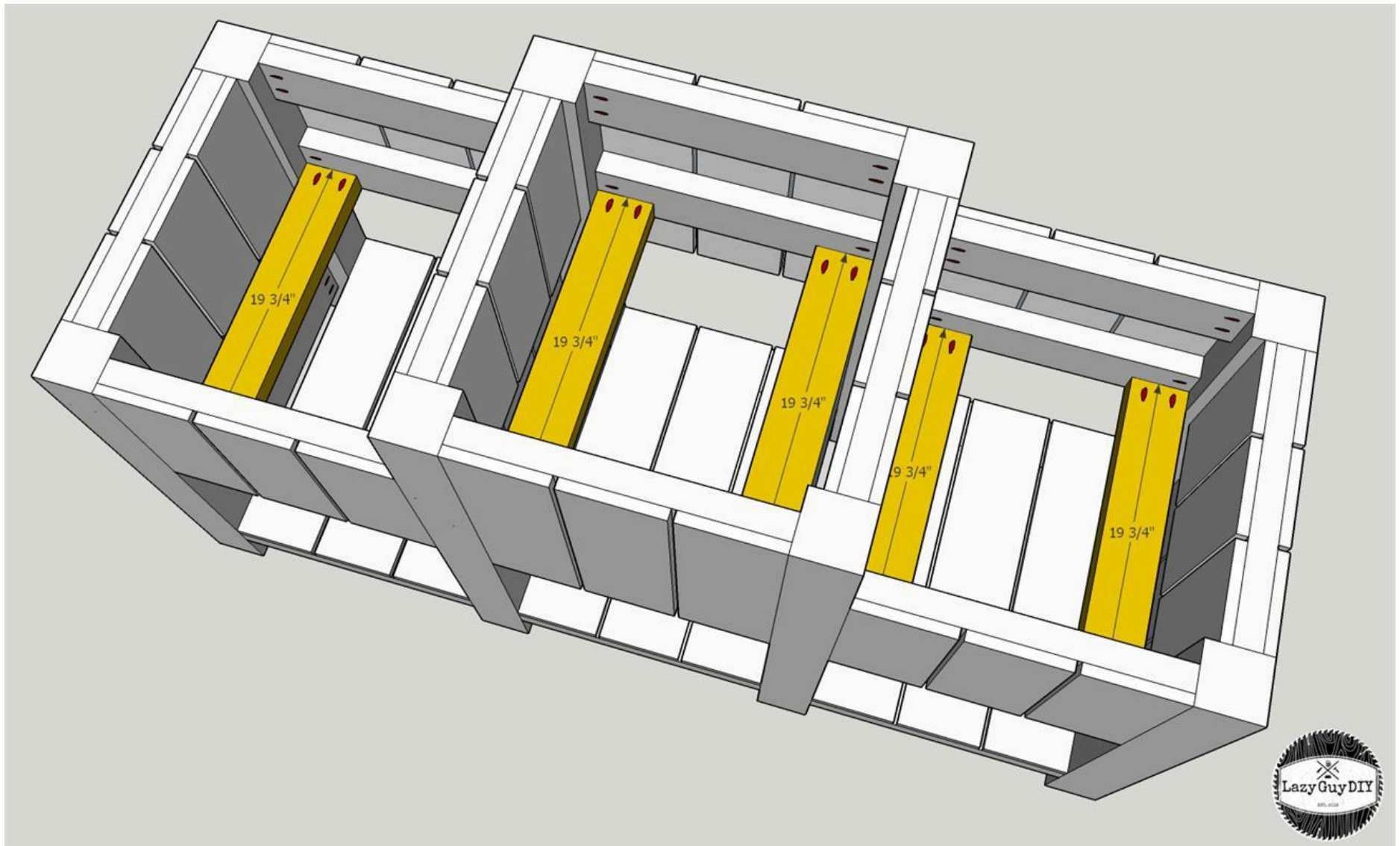

# 9

## Step 9 - Install Planter Shelves

For each planter box, cut (3) 17" cedar planks and install with exterior wood glue and stainless steel brad nails. Space each plank equally. The spacing will be slightly wider. This entire area will be covered with gardening cloth so measurements do not need to be perfect, it only needs to support the dirt and plants.

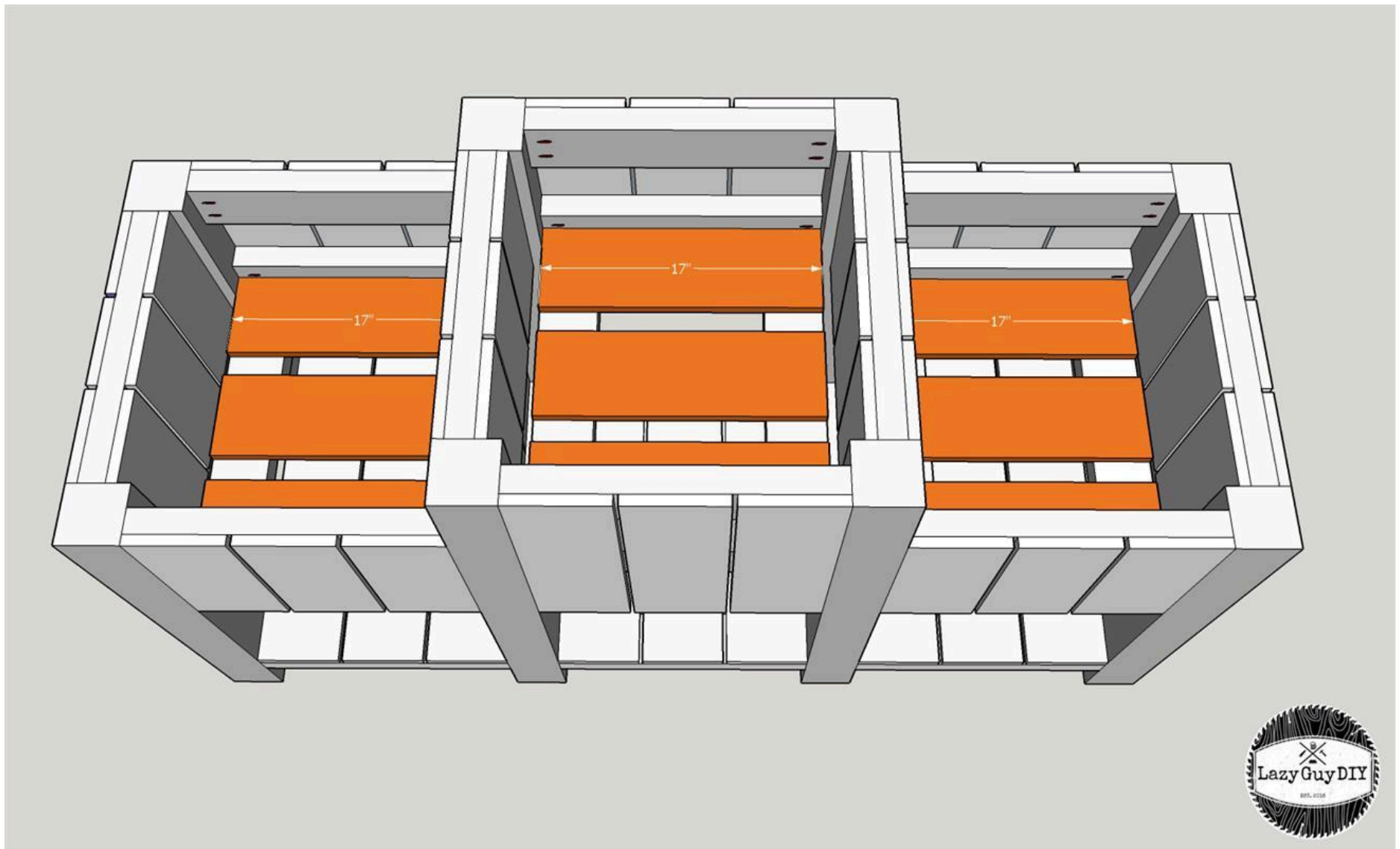



**10****Step 10 - Install Final Planks**

Cut (3) cedar planks to  $9\frac{7}{8}$ 's for each remaining panel and install with exterior wood glue and stainless steel brad nails. It's okay if you're running low on cedar planks and you have to compromise the length of a few. These will all be covered by the gardening cloth and dirt.

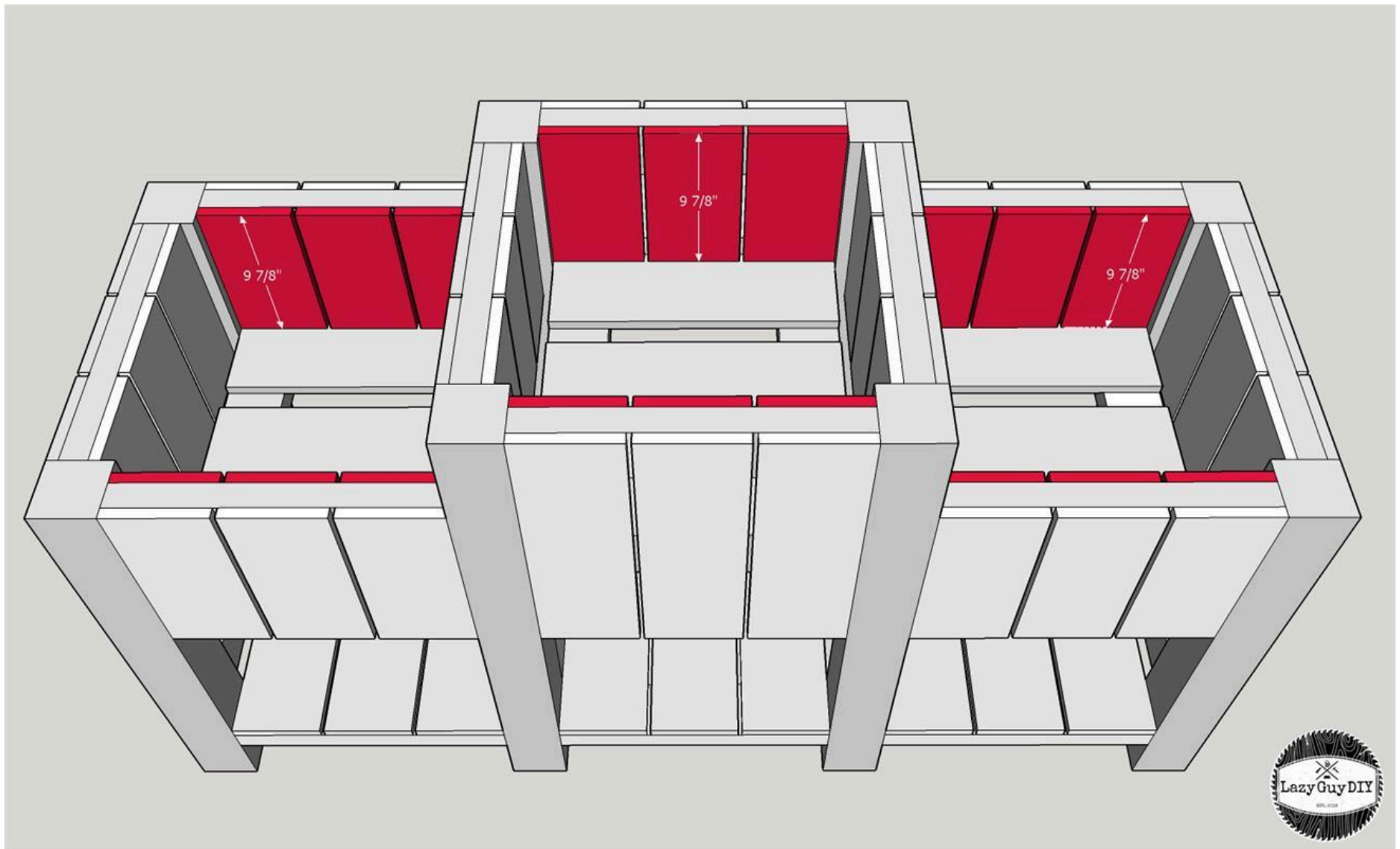



**11****Step - 11 - Install Garden Cloth**

There is no great method for installing gardening cloth to line each planter. Make sure you choose a type that is durable and won't easily tear if you staple it into the frame. I ended up doubling up in a few areas just to make it extra secure. It can easily be pulled out once it has worn out and a fresh one installed the next season.

Add dirt, plant your plants and enjoy!

